

Township	BELL PLAIN
Co. Aid Project	102
Structure #	062-4717

Request for County Aid for Township Drainage Structure

The undersigned Commissioner of Highways of BELL PLAIN Road District in Marshall County, Illinois, hereby petitions you for aid as provided for in Chapter 605, Section 5/5-501, of the Illinois Compiled Statutes, for an appropriation from the County Board Bridge Fund in the County Treasury, a sum sufficient to meet one-half the expense required on the condition that said Road District shall furnish the other one-half of the required amount.

Repair Bridge No. 062-4717 carrying TR-126 (N. Pattonsburg Rd) over a branch of Crow Creek. The existing bridge is a timber pile structure that has been recently downgraded to a weight limit of 3 tons. It is located in Section 35, T29N R1W 3rd PM.

The total cost of said work will be approximately \$50,000. The County and Township will share the cost, approximately \$25,000 each.

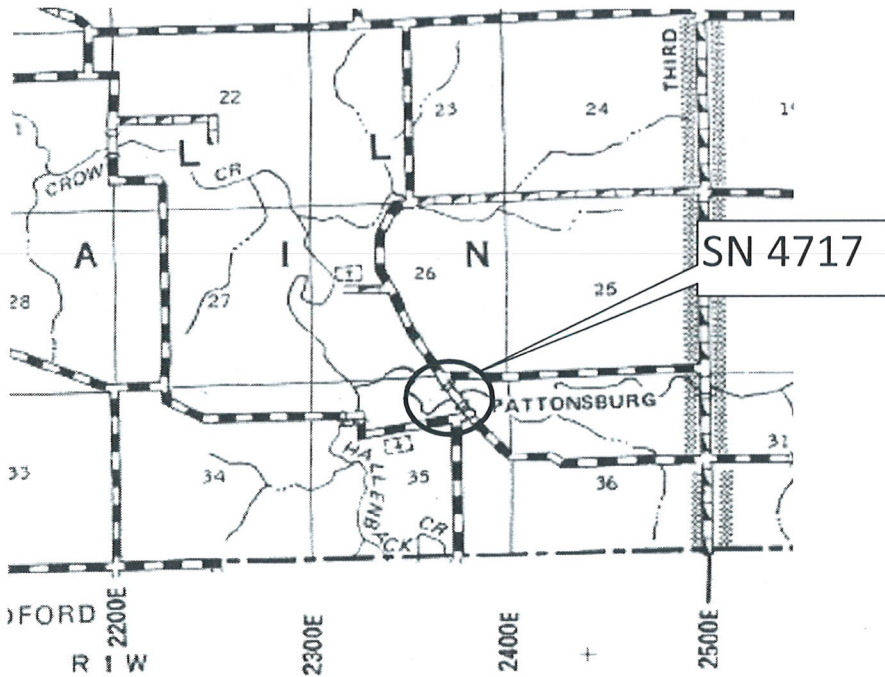

I, James Lutz, Commissioner of Highways for Bell Plain Road District, further certify that the present structure is inadequate, that the proposed work is necessary, and that the estimated cost of the project is more than 0.02% of the equalized assessed valuation of the Township; and that they tax levy for road purposes in this Road District was, in each of the last two years, not less than the maximum allowable rate provided for in Chapter 605, Section 5/6-501 of the Illinois Compiled Statutes.

James Lutz

 Highway Commissioner

Approved by the County Board of Marshall County, Illinois at its regular meeting held in Lacon, Illinois on May 14, 2015.

Melody A Weber

 Marshall County Clerk