

Request for County Aid for Township Drainage Structure

Township
Co. Aid Project
Structure #

Evans
302
062-4549

The undersigned Commissioner of Highways of EVANS Road District in Marshall County, Illinois, hereby petitions you for aid as provided for in Chapter 605, Section 5/5-501, of the Illinois Compiled Statutes, for an appropriation from the County Board Bridge Fund in the County Treasury, a sum sufficient to meet one-half the expense required on the condition that said Road District shall furnish the other one-half of the required amount.

A bridge required repair over a tributary of Sandy Creek on TR 104A (County Road 3100E) between Marshall County and LaSalle County for a road maintained by Evans Township.

The total cost of said work will be approximately \$80,000. LaSalle County will pay 50% and Marshall County and Evans Township will split the remainder (\$20,000 for Marshall County).

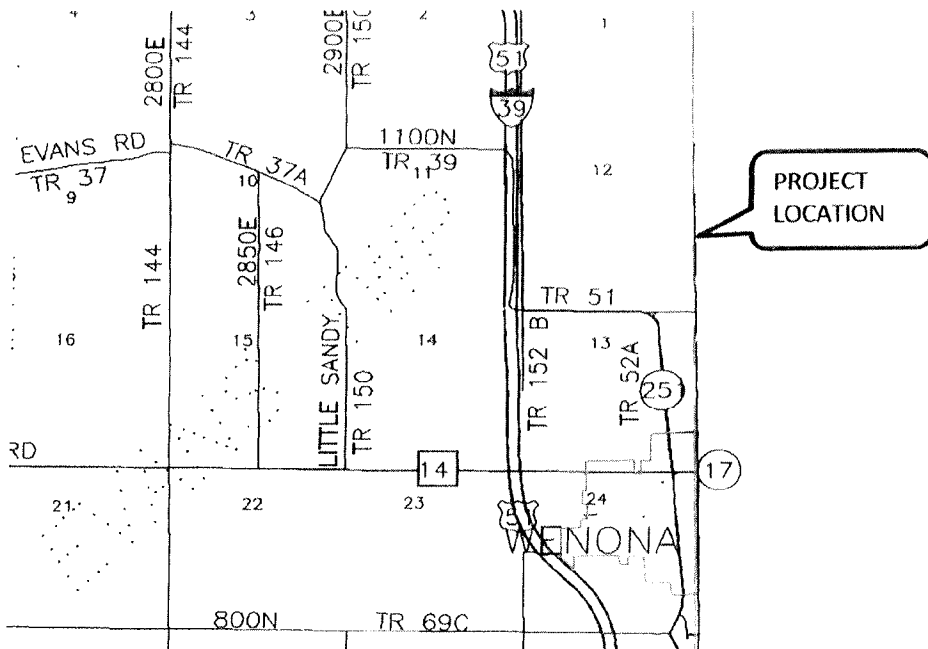

I, John Lauf, Commissioner of Highways for EVANS Road District, further certify that the present structure is inadequate and that the proposed work is necessary, and that the estimated cost of the project is more than 0.02% of the equalized assessed valuation of the Township; and that they tax levy for road purposes in this Road District was, in each of the last two years, not less than the maximum allowable rate provided for in Chapter 605, Section 5/6-501 of the Illinois Compiled Statutes.

John E. Lauf
Highway Commissioner

Approved by the County Board of Marshall County, Illinois at its regular meeting held in Lacon, Illinois on February 11, 2016.

Melody A Weber
Marshall County Clerk